

2820 Series Accessories

2820 DAP 2820 SAP

Introduction

The Briton 2820 Series floor springs are suitable for single or double action doors. A series of accessories is available to suit timber or metal doors.

Double Action - Briton 2820 DAP

Two part top pivot accessory with lateral adjustment screw accessed from the edge of door. Top pivot is retractable to allow the door to be installed/removed.

Bottom strap to align with floor spring spindle.

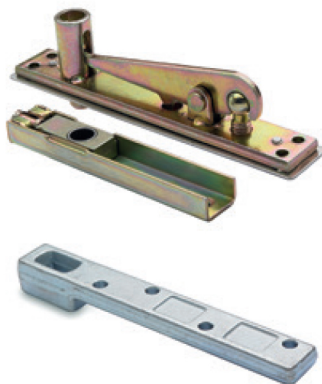

2820 DAP



2820 SAP

Single Action - Briton 2820 SAP

Two part top pivot accessory with cover caps. This assembly is reversible for left or right hand doors.

Bottom strap with cover cap to align with floor spring spindle.

Product Ref:	Description
2820 DAP	Double action accessory pack
2820 SAP	Single action accessory pack
2820.IP.DAP	Intumescent fire protection pack for double action doors and accessories
2820.IP.SAP	Intumescent fire protection pack for single action doors and accessories



Certification

Fire tested to EN 1634-1 for use on fire doors up to 1hr timber

Environmental Product Declaration in accordance with ISO 14025 & EN15804

DoP available at www.britondops.co.uk