



# 6000 Series

Door furniture



Fire Rated: Tested on fire door assemblies in accordance with Australian Standards, refer fire door manufacturer for specific approval details

Legge offers a range of leading hardware furniture designs for commercial and quality residential applications. Legge 6000 Series has a round rose with a wide selection of designer levers to choose from.

The Legge 6000 Series will enhance the standard and elegance of any residential and commercial applications including apartments, office fitouts, hotels, and high end homes.

## Features

- Constructed of quality components, with forged brass levers and die cast inner roses
- Levers non-handed, except for Alessandro and Chagall when used as either a half set or half set fixed
- All Legge 6000 Series levers are available in a square rose option by adding the optional outer square rose cap
- Furniture re-handed by simple relocation of stop block
- Heavy duty spring provides a smooth, positive return action of the lever and eliminates drooping, extending the life of the product
- The 10 year mechanical warranty provides specifiers and users with assured quality and performance
- Suitable for use on fire door assemblies when used with fire rated locks and latches

# Specification guide







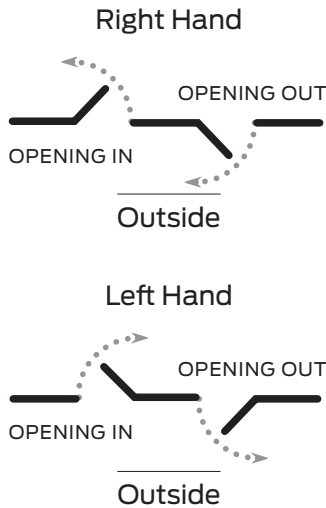

Function	Lever	Finish
Lock/latch furniture ..... 6000	refer following pages	Antique bronze ..... A
Half set ..... 6001		Chrome plate ..... C
Half set fixed ..... 6002		Oil rubbed bronze ..... ORB
Blank rose ..... 6003		Polished brass ..... P
Passage latch set ..... 6005		Polished brass unlacquered ..... PU
Privacy latch set ..... 6006		Satin chrome plate ..... S
		Satin black chrome ..... SBC
		Satin brass ..... SB
		Satin brass unlacquered ..... SBU

- 1. Function**  
Select the desired function e.g. Passage set ..... 6005
- 2. Lever**  
Select the required lever design - e.g. Leonardo #12 ..... 6005/12
- 3. Finish**  
Select the desired finish e.g. Satin chrome plate ..... 6005/12S

# Handing guide



Specifications	
<b>Door type</b>	Timber or metal
<b>Door thickness</b>	Latch furniture 32mm to 50mm Passage set 32mm to 50mm Privacy set 32mm to 42mm
<b>Backset</b>	60mm
<b>Spindle size</b>	7.6mm
<b>Compatible locks/ latches</b>	Schlage ME Series mortice locks Legge 990MF Series mortice locks
<b>Fixing</b>	Bolt-through concealed fixing. Screw length 75mm
<b>Materials</b>	Forged brass handles, zinc die cast roses
<b>Finishes</b>	Antique bronze, Chrome plate, Oil rubbed bronze, Polished brass, Polish brass unlacquered, Satin chrome plate, Satin black chrome, Satin brass, and Satin brass unlacquered
<b>Warranty</b>	10 year mechanical 10 year finish for C, P, PU, S, SB and SBU 1 year finish A, ORB, and SBC

Functions	Outside	Inside
<b>6000 - Lock/latch furniture</b> Pair of levers to be used with a latch or mortice lock or converted to dummy trim with fixing kit		
<b>6001 - Half set</b> Single lever to be used with a latch or converted to dummy trim with fixing kit		
<b>6002 - Half set fixed</b> Single inactive lever which is used as a door pull or matching trim		
<b>6003 - Blank rose</b> Used with a single lever for through fixing		
<b>6005 - Passage latchset (60mm backset)</b> Both levers always unlocked		
<b>6006 - Privacy latchset (60mm backset)</b> Push-button locks outside lever (outside emergency release). Inside lever unlocks door		

## Legge 6000 Series levers

**Alessandro #55** 

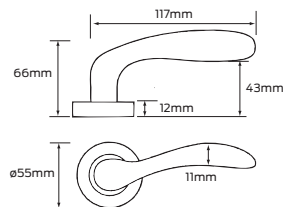

**Alpha #29**

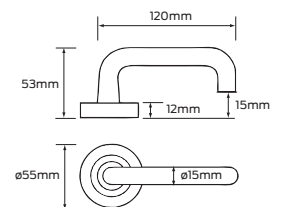

**Angelo #57**

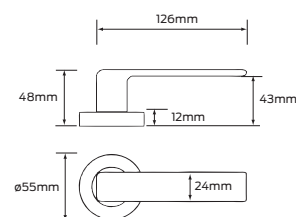

**Bergen**

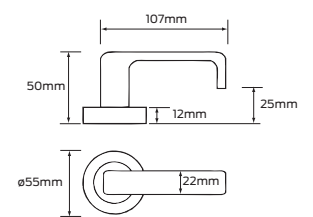

# Legge 6000 Series levers

**Chagall #51** 

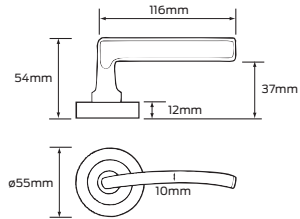

**Cisa #59**

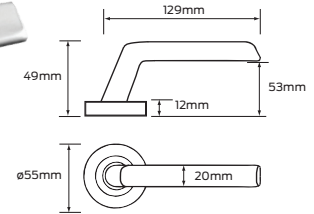

**Diablo #15**

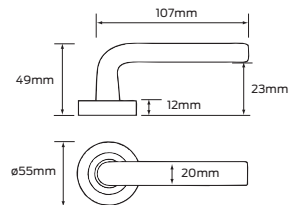

**Ergo #62**

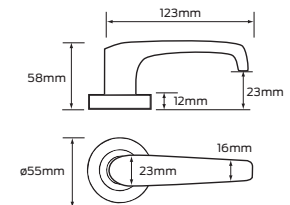

**Leonardo #12**

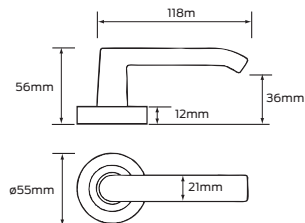

**Monet #50**

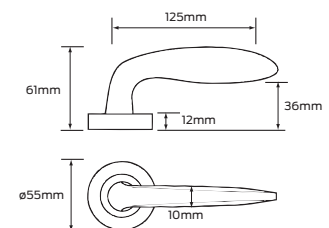

## Legge 6000 Series levers

**Neptune**

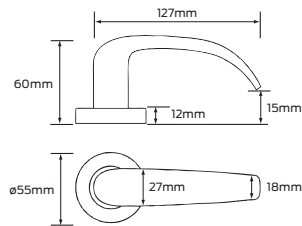

**Renoir #52**

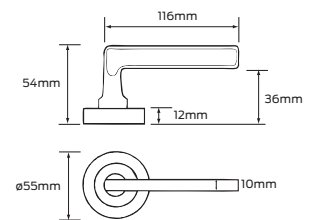

**Rubens #56**

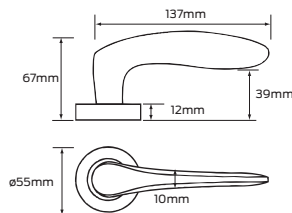

**Salvador #27**

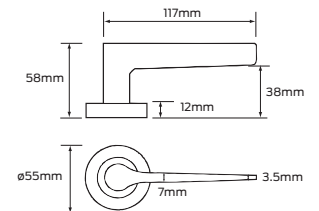

**Trilo #61**

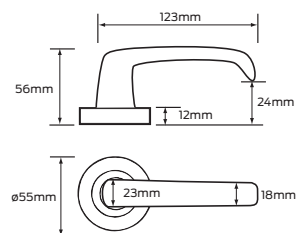

# Legge 6000 Series escutcheons and spare parts

**Cylinder #6008**

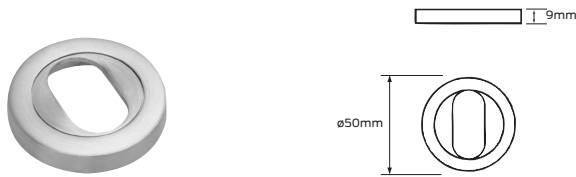

**Euro profile cylinder #6012**

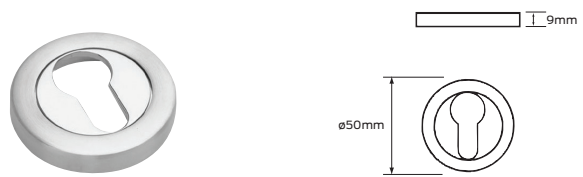

**Emergency release #6009**



**Indicating emergency release #6014**

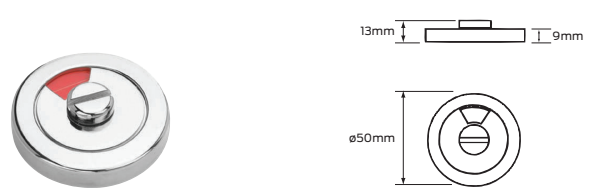

**Indicating turn #6013**

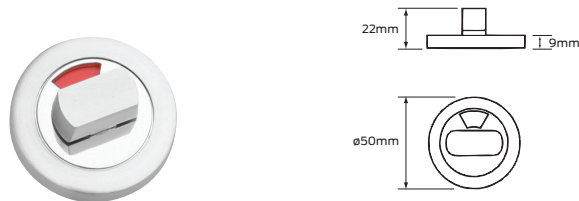

**Turn #6007**



**Large turn #6010**

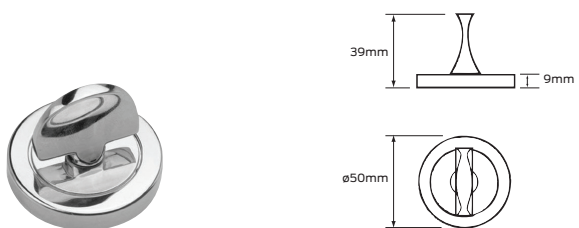

**Indicating large turn #6015**

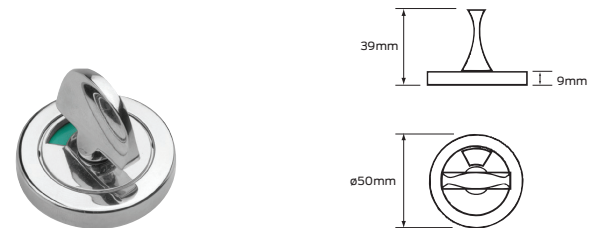

**Accessible turn #6054**

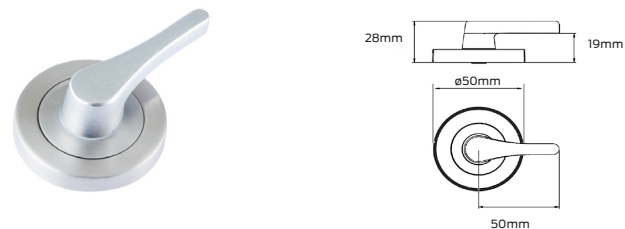

**Indicating accessible turn #6054IND**

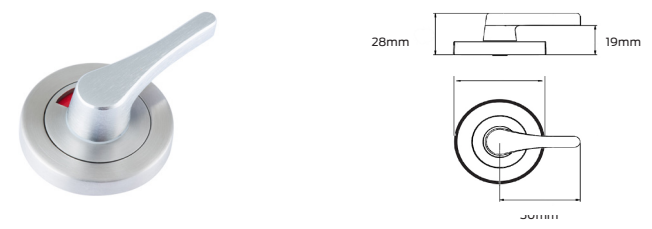

Depicted in RH

Depicted in RH

**Dummy trim fixing kit**

Allows conversion of latch furniture to dummy trim function. One kit required per handle

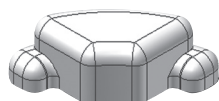

Denotes handed lever/ Turn Snib

# Legge 8000 Series escutcheons and spare parts

## Square outer rose option passage #Z800102

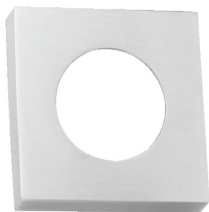

Add this cap with the preferred Legge 6000 Series lever as a square rose option for passage or latch furniture functions (excludes privacy option and two units required for a furniture set).

### Cylinder #8008

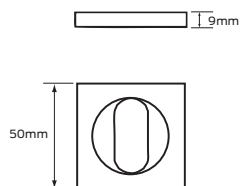

## Square outer rose option privacy #Z800202



Add this cap with the preferred Legge 6000 Series lever as a square rose option for privacy furniture functions (not suitable for passage or latch furniture and two units required for a furniture set)

### Euro profile cylinder #8012

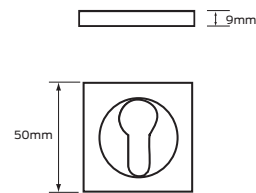

## Emergency release #8009

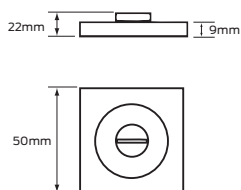

## Indicating emergency release #8014

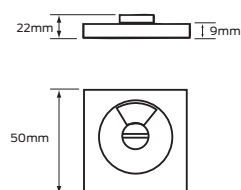

## Indicating large turn #8015

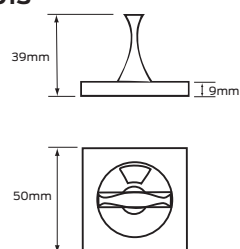

## Indicating turn #8013

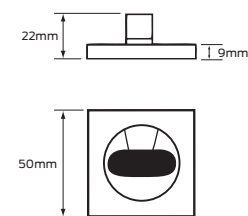

## Large turn #8010

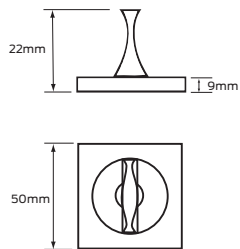

## Turn #8007

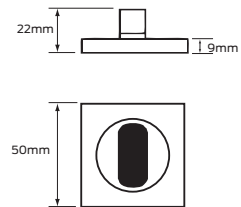

## Accessible turn #8054

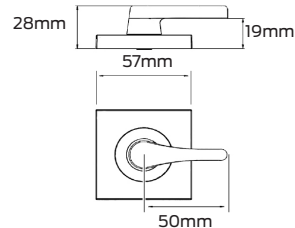

Depicted in RH

## Indicating accessible turn #8054IND

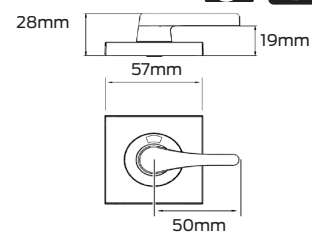

Depicted in RH



Denotes handed lever/ Turn Snib