

**halliday
baillie**

HB 690 - 170mm FLUSH PULLS SLIDING DOOR PRIVACY SET - 55mm BACKSET

The iconic Halliday+Baillie HB 690 sliding door privacy set features an integrated push button-activated edge pull for pocketed doors. The operable "snib" (a slide block that acts like a traditional thumb turn) slides upwards to engage the lock. The discrete emergency release indicator pull can be operated with a pen or other object to disengage the lock from the outside.

In double door conditions, for the passive leaf specify the HB 697 Strike Body w/Edge Pull and add HB 660 Flush Pulls where a matching face plate is required.

Backset : 55mm
Minimum door thickness : 38mm
Flush pulls : 170 x 36 x 14
Internal grip depth : 11mm

Suitable for timber or wide profile aluminium doors

Standard HB 690 set includes :

- HB 690 Series Lock Body
- Two HB 660 Flush Pulls
- HB 604 Fixing Kits (one set for HB 693)
- Strike and Dust Box
- Two spindle lengths (please specify door thickness)
- Fasteners

Configurations :

HB690 : Privacy Set, Snib Inside, ER Indicator Outside
HB692 : Snib Inside, Blank Outside
HB693 : Snib Inside, No Pull Outside
HB694 : Snib both Sides
HB691 : Body Only no End Pulls
HB697 : Body + End Pull, no Bolt

Available in all standard Halliday + Baillie finishes, see finishes sheet for further details.



dustbox and strike plate



To be used with the HB 604 Timber fixing Kit on timber doors



Snib/Key
HB 690 configuration

Snib/Indicator
HB 692 configuration

Snib/Blank
HB 693 configuration

Snib/Snib
HB 694 configuration

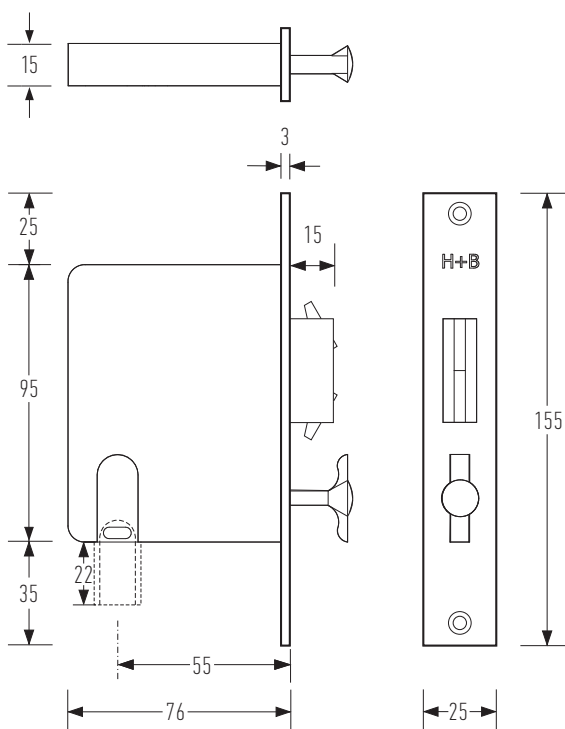

Designed and manufactured in New Zealand. For more information, installation templates, and measured drawings of this product and others please visit : www.hallidaybaillie.com or contact your authorized Halliday + Baillie dealer. All information subject to change.