

# Technical Data Sheet

## P436 Flat Strap Centre line Pivot

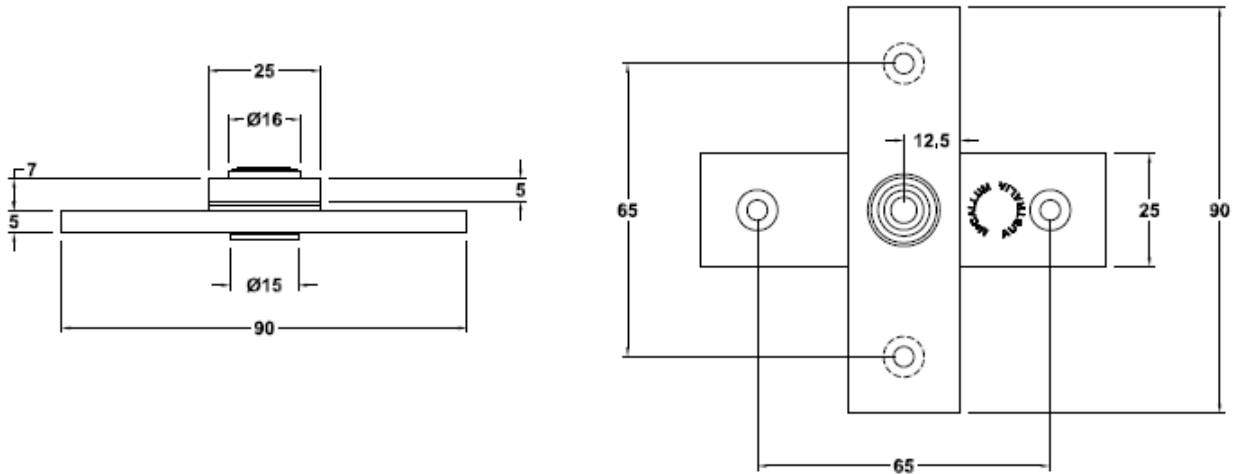

### SPECIFICATION

- **Pivot Type:** Centre Line
- **Pivot:** High strength Aluminium Alloy T6 minimum tensile 254 mpa
- **Rivet:** Steel Zinc Plated
- **Bushes:** Nylon 6 Bearing Bush
- **Geometry:** Centre line non-handed Pivots
- **Maximum Weight Capacity:** 50kg

### FINISH

- P435SIL – Silver Powder Coat

### INSTALLATION GUIDE

- Door Thickness 35 - 45mm
- Suitable for Timber doors
- Suits both open in and open out doors
- As a guide suits standard doors up to:
  - 2400 high x 920 wide up to 50kg

### FIXING

- Fastening screws supplied