

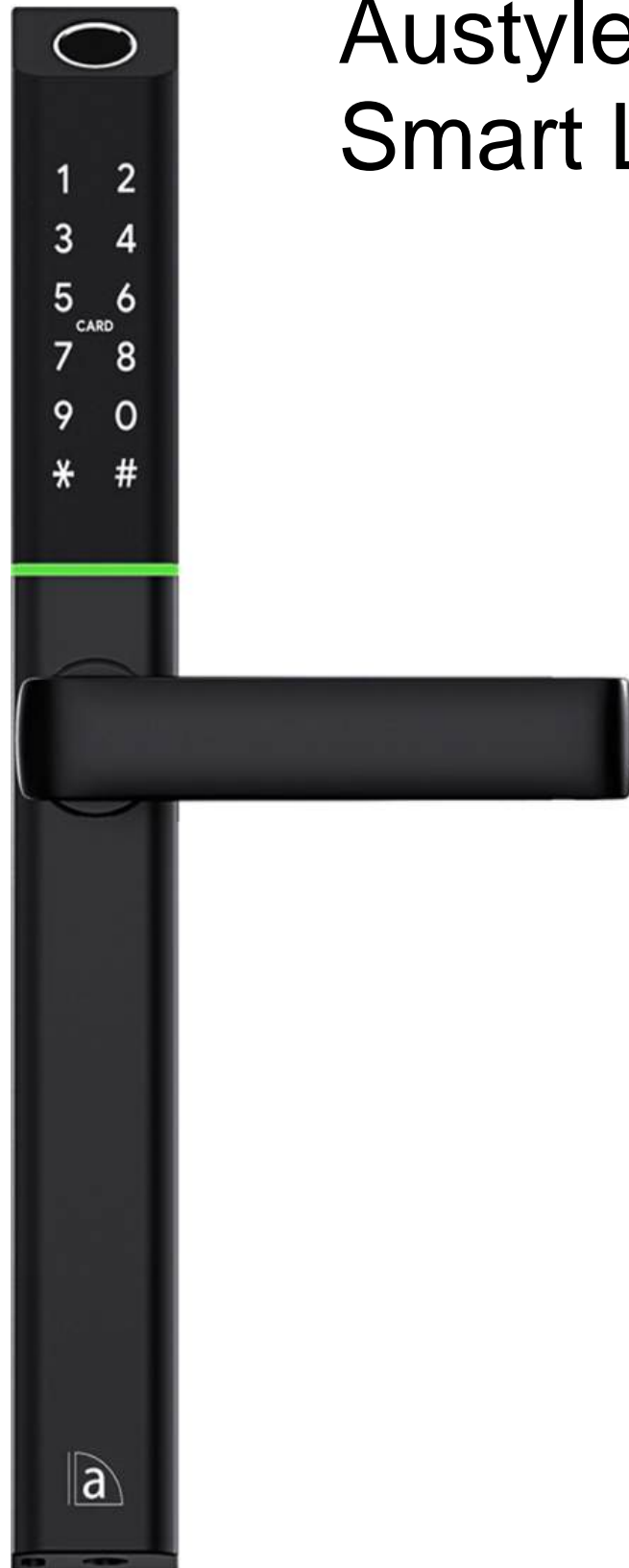

# Austyle Digital Smart Lock



# 59407

## INSTALLATION INSTRUCTIONS

# Introduction

---

Thank you for choosing the Austyle digital smart lock. This lock is designed for residential use only. The one-year (mechanical and electronic) warranty applies only to locks used in residential installations.

To ensure you get the best out of your purchase, please follow the guidelines below:

- Please read these instructions fully before installing this lock.
- We recommend that this lock be installed by a professional installer or a competent DIYer to ensure correct installation and operation.
- This digital smart lock requires installation on a smooth, flat surface to maintain its water tightness. It is not suitable for use on a tongue-and-groove door, as water can penetrate the lock through the groove.
- We recommend that this lock never be fully exposed to direct weather for extended periods. For long-lasting functionality, position the lock under an eave or in a sheltered area, away from direct sunlight and rain.
- The exterior of the lock is rated IP55. No warranty is provided for damage caused by water entering from the inside of the door.
- This lock is not suitable for use on a gate.
- This lock comes with a mechanical key override that can be used in case of battery loss. We recommend keeping the override key in a safe location outside in case this situation occurs.
- Replace the batteries when the app indicates low voltage.
- All batteries used with this lock must be high-quality alkaline (4 x AAA batteries) to ensure the electronic components function smoothly and consistently.
- Lithium or rechargeable batteries cannot be used with this lock.

# Lock Dimensions

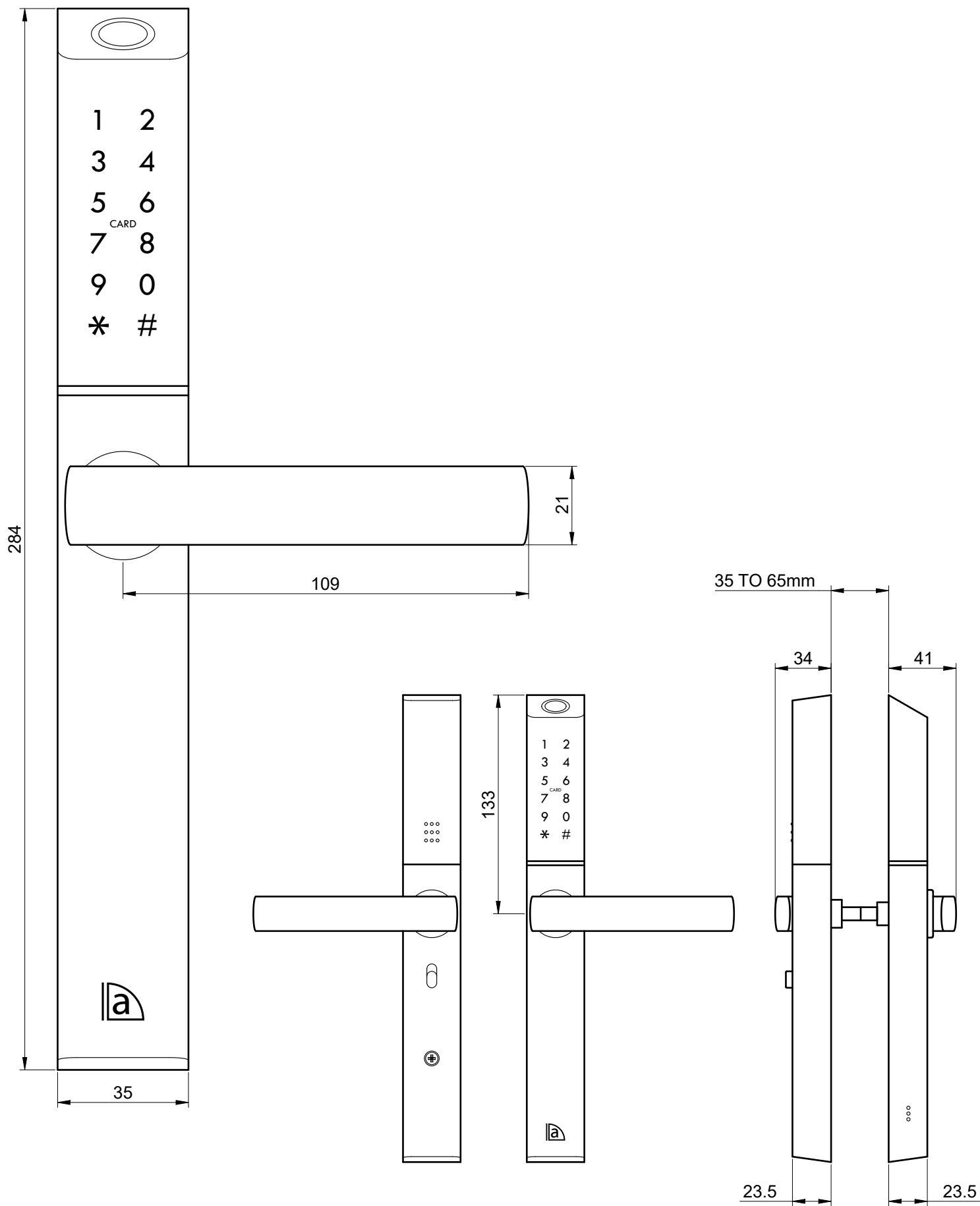



# 59407 Set-up For Use With LATCH

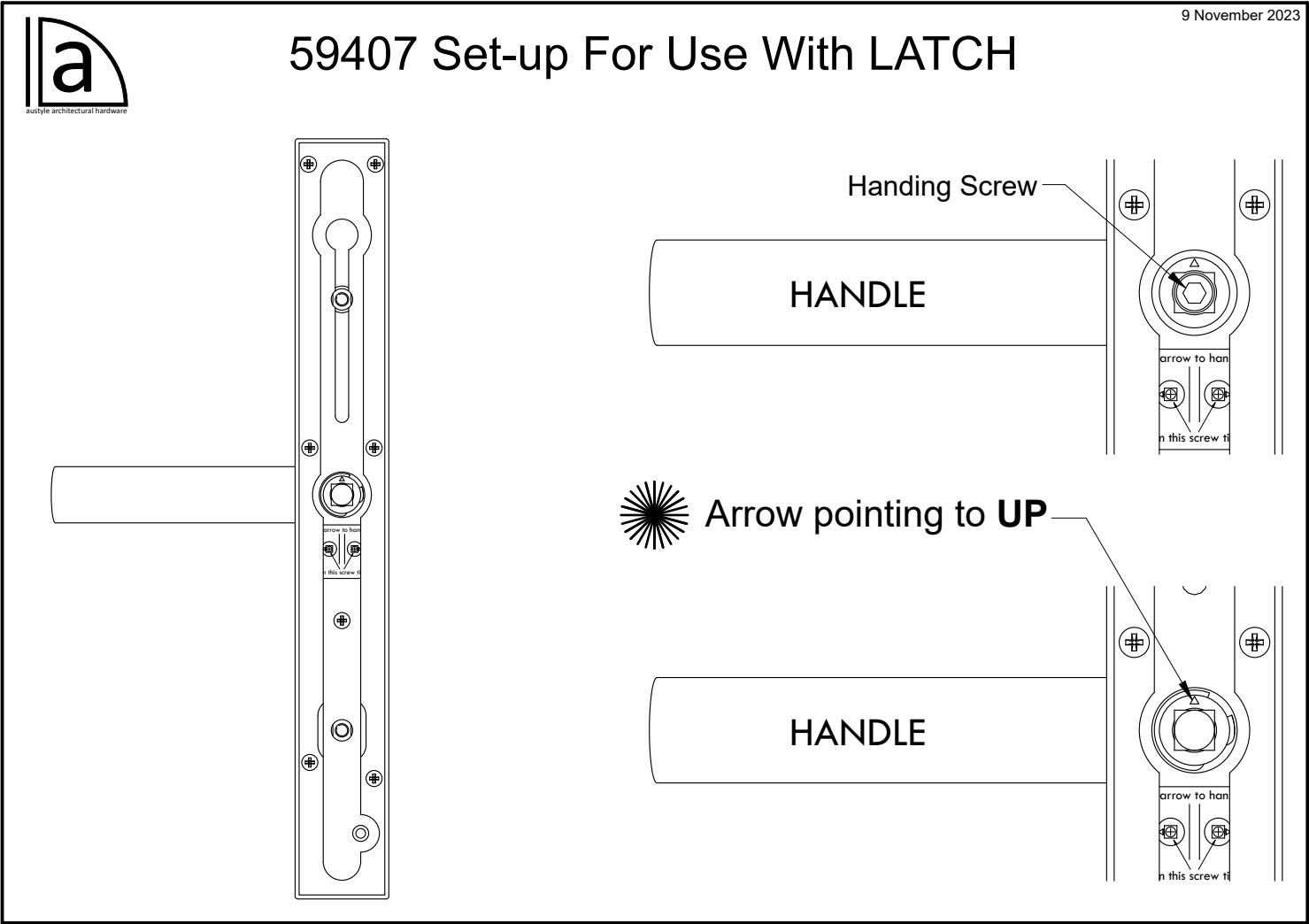

# 59407 Set-up For Use With MORTISE LOCK

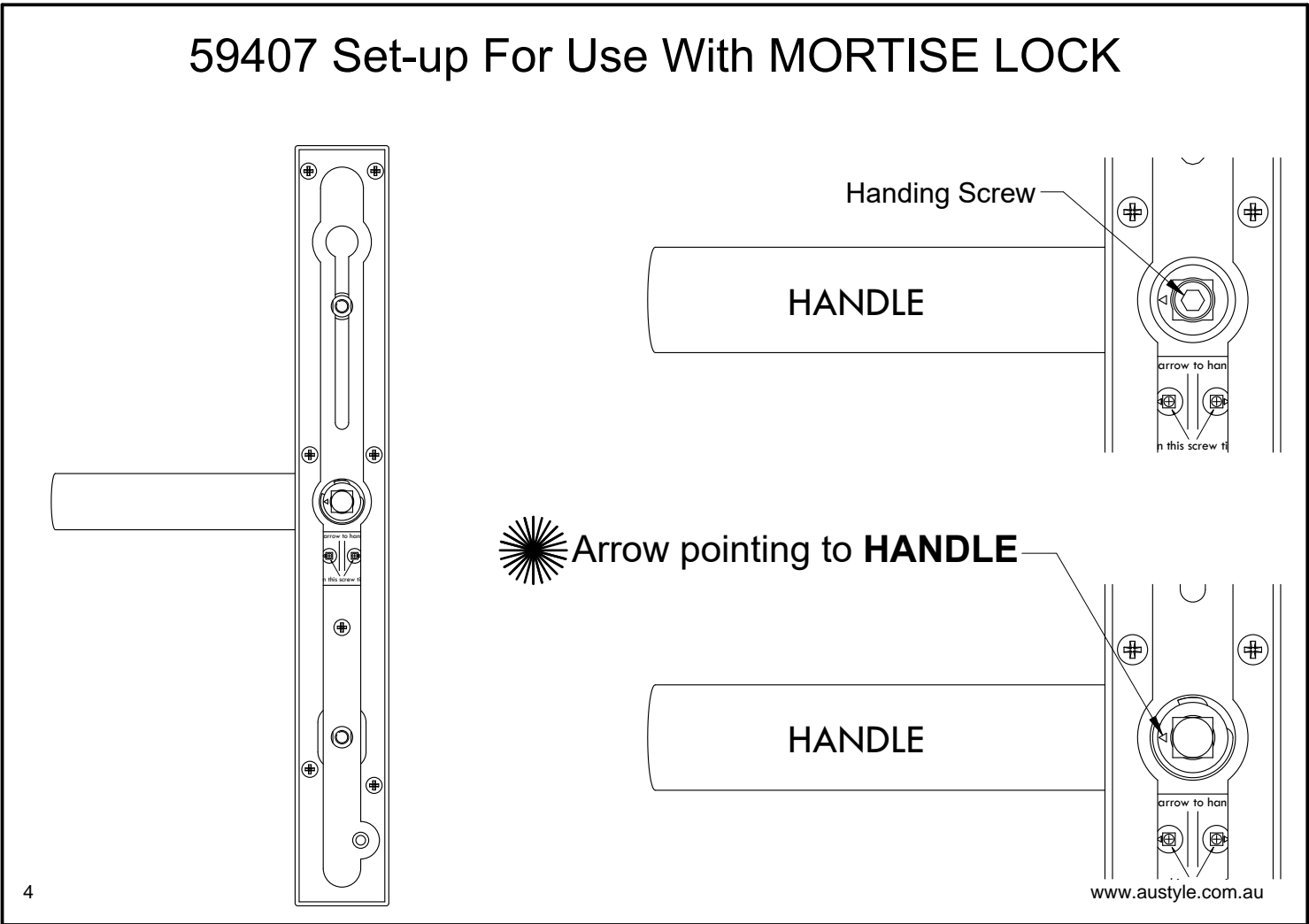

# 59407 Packing List



Exterior Panel  
Qty x 1



Screws #8 x 25mm Qty x 4  
(For timber door)



Interior Panel  
Qty x 1



Screws M5 x 10mm Qty x 4  
(For aluminium door)

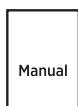

User Manual Qty x 1

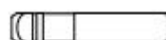

Spindle Qty x 1  
(50mm, 57mm, 67mm)



Installation Template Qty x 1



RFID Tag Qty x 3



Sliding T-slot screw M5 x 11mm  
Qty x 1



Self Adhesive Disc  
(Sold separately)



Mechanical Keys Qty x 2

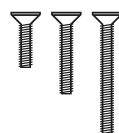

Various M5 machine screws Qty x 1  
(25mm, 30mm, 40mm, 50mm, 60mm)



Allen Key Qty x 1

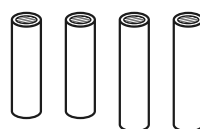

Threaded sleeve  
M5 x 30mm Qty x 2,  
M5 x 35mm Qty x 2

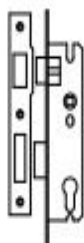

Mortise Lock Qty x 1



U-Spring Qty x 1

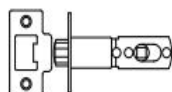

Latch Qty x 1



WiFi hub Qty x 1  
(Sold separately)

# 59407 INSTALLATION INSTRUCTIONS

## Product specifications:

<b>Model number</b>	59407	<b>Door thickness range</b>	35mm - 65mm
<b>Material of Manufacture</b>	Aluminum alloy	<b>IP rating</b>	IP55
<b>Weight</b>	2.5 kg	<b>Type of use</b>	Residential use only
<b>Options of unlocking</b>	Blue tooth Finger print Passcode Card Mechanical key Gateway (optional) Disc (optional)	<b>Passcode capacity</b>	App unlocks infinite Fingerprints: 200 max Passcodes: 150 max RFID Cards: 200 max
<b>Working temperature</b>	-10 to + 55 degrees C	<b>Working Humidity</b>	0-95%
<b>Normal voltage</b>	6 volts (4 x Alkaline batteries)	<b>Warranty</b>	1 year mechanical
			1 year electronic
<b>Low voltage Alarm</b>	Less than 4.8 Volts	<b>Mortise Lock</b>	Stainless steel body
<b>Lever handing</b>	Reversible	<b>Latch</b>	Reversible

### Anti Peeping Technology

This lock offers anti-peeping virtual passcode entry by inputting a random passcode either before or after the proper passcode followed by the # key.

# Installation:

## Check handing of the mortise lock

Below are the instructions to change handing if required.

### Step 1:

Flip lock body upside down

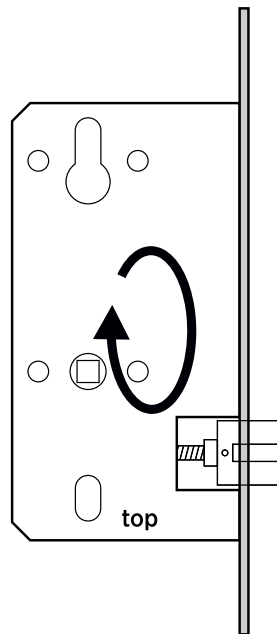

### Step 2:

Depress latch mechanism into lock body

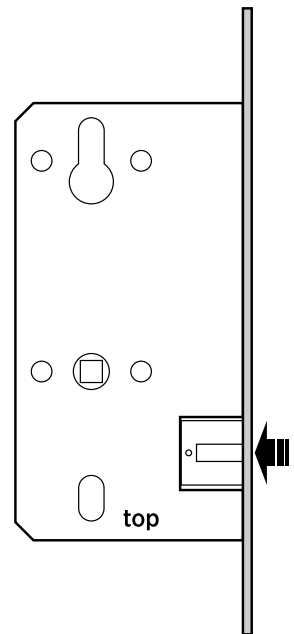

### Step 3:

Rotate latch mechanism

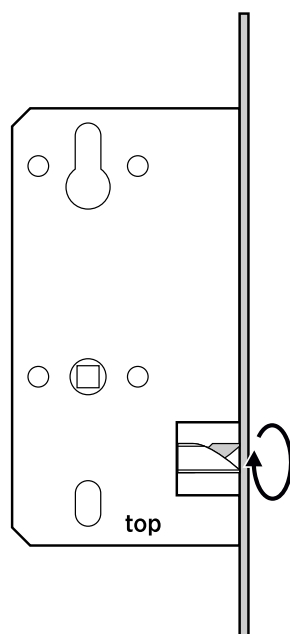
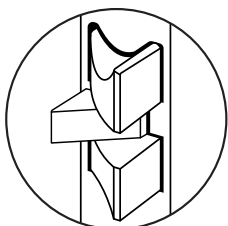

### Step 4:

Align and release latch mechanism,

#### **⚠ IMPORTANT**

Make sure to correctly align the center latch otherwise the lock will not function correctly.

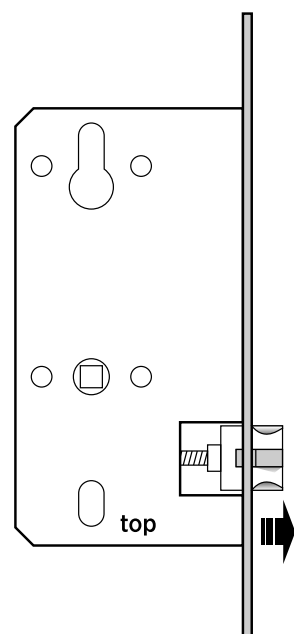
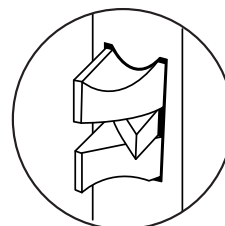

# 59407 INSTALLATION INSTRUCTIONS

## Installation:

Check handing of the lever

Instructions to change handing:

### For Exterior Assembly:

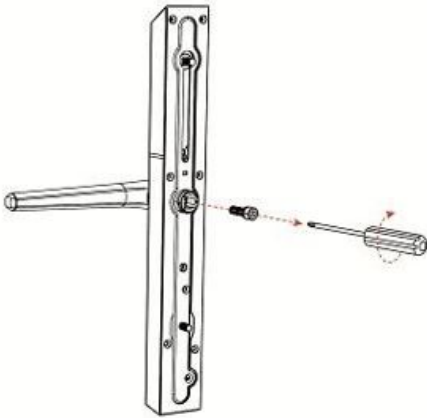

1. Remove handing Screw

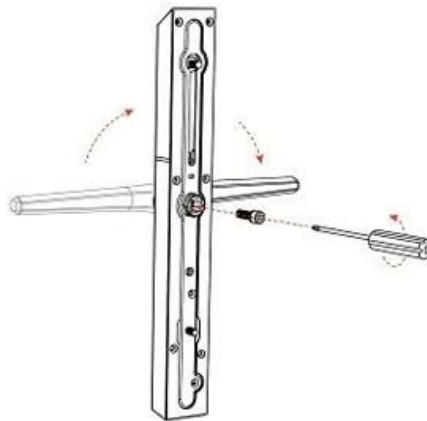

2. Remove and rotate the handle to the left or right depending on handing direction

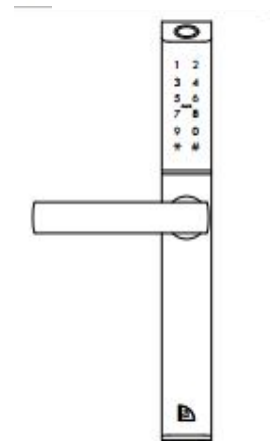

3. Re-insert the screw (using thread locker recommended) after adjusting handing direction

### For Interior Assembly :



1. Remove handing screw



2. Remove and rotate the handle to the left or right depending on handing direction

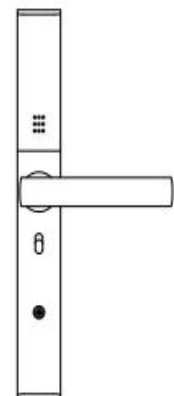

3. Re-insert the screw (using thread locker recommended) after adjusting handing direction



# Installation:

## Step 1: Install Mortise Lock (see mortise lock instructions and template)

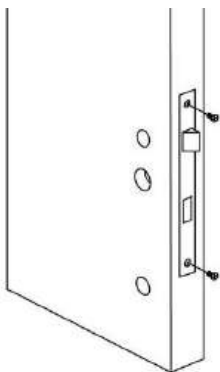

1. Mark and drill door using installation template provided.  
For more detailed instructions, refer to our website [www.austyle.com.au](http://www.austyle.com.au)
2. Ensure holes are clear of any sharp edges and clean of swarf and wood dust.
3. Adjust tongue of latch depending on the way the door operates (refer to page 7)

## Step 2: Install Exterior Panel Fittings

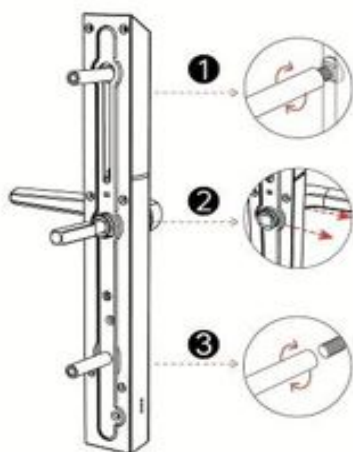

**⚠ IMPORTANT**

1. Choose a pair of threaded sleeves suitable for the thickness of the door. Insert the T-slot screw into one or the threaded sleeves loosely. Insert head of T-slot screw into upper slot in the back of the exterior panel. Slide the T-slot screw to the required position and tighten.
2. Install the correct length spindle into the follower and fit the U-spring.
3. Screw the other threaded sleeve onto the lower stud on the back and tighten.
4. Orientation of Follower Arrow as per page 4.

## Step 3: Install Exterior Panel

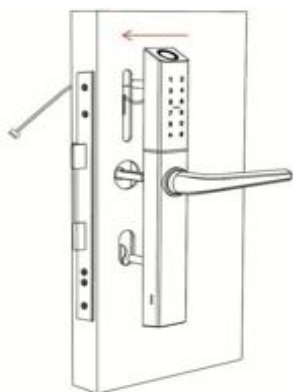

Align exterior panel with the holes in the door and feed the cable through the door.

# 59407 INSTALLATION INSTRUCTIONS

## Step 4: Install Interior Lock Panel

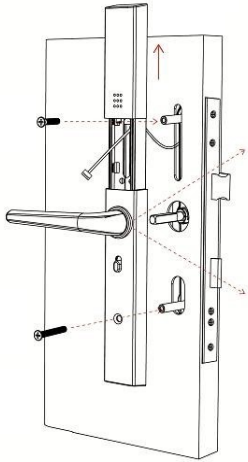

1. Carefully remove battery cover from interior panel and connect cable ensuring there is adequate space within the door for it to prevent any crush issues.

### **⚠ IMPORTANT**

Plug in power cable ensuring the plug is around the correct way for the plug to accept its receiver correctly.

2. Select the fixing screws that are the correct length to fit the lock to the door.
3. Before final tighten ensure the lock is sitting vertical and that no excess cables have been caught against the door.
4. Finally, hand tighten the screws to attach the lock to the door face.

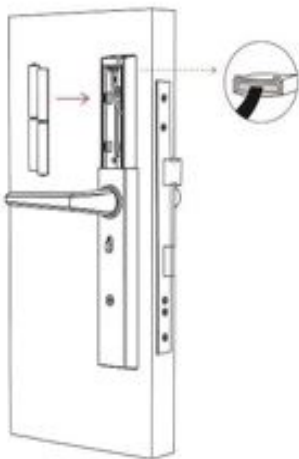

### **⚠ IMPORTANT**

Do not pull on the plug or cable with force or let the hardware hang from the cable, damaged caused will void the warranty



5. Install the correct type of batteries into the lock (4 x Alkaline AAA batteries)
6. Re-attach battery cover plate
7. Finally fit striker plate and striker box to the door frame ensuring that the latch and bolts work freely when the door is closed.
8. To test the correct operation of the deadbolt of the lock test by lifting the inside handle up and ensuring it runs freely into the striker plate without any resistance. If binding occurs the striker plate might need a re-adjustment in position.
9. Installation of the lock is now complete

# Lock Installation Checklist

---

1. Holes drilled and aligned as per drilling template.
2. Arrow on spindle hub points as per Latch/Lock set up guide.
3. Ensure U-spring is installed correctly, securing the spindle.
4. Ensure all screws are correctly tightened.
5. Ensure power cable is installed and not bent or crimped in door.
6. Check batteries are Alkaline and installed correctly.
7. Check to see if the lock requires a software update via the TT App

1. Date Installed:     /     /
2. Installed By:
3. Pin:               #



---

## Manual reset to factory settings:

If you are not the administrator of the Smart Lock, remove battery cover and complete as follows:

1. Long press the reset button beneath the battery case for 5 seconds or until you hear: "Please Input Initialisation Passcode".
2. Input code "000#" on the keypad.

The system reset will be complete. From here you can re-link the 59407 Smart Lock to your phone via the TTLock App.

*\*Note: this will clear all previous users from the lock's memory*

Reset Button



# 59407 INSTALLATION INSTRUCTIONS

## Using your Austyle 59407 Smart Lock

Your Austyle 59407 has two handle functions when installed with a Mortise Lock:

Lift up the handle to engage the mortise deadbolt.

Pull down to unlock and release latch + deadbolt

**Important Notes:** When the smart lock automatically locks, the handle disengages from the latch, but you can still lift the handle to engage the mortise bolt.

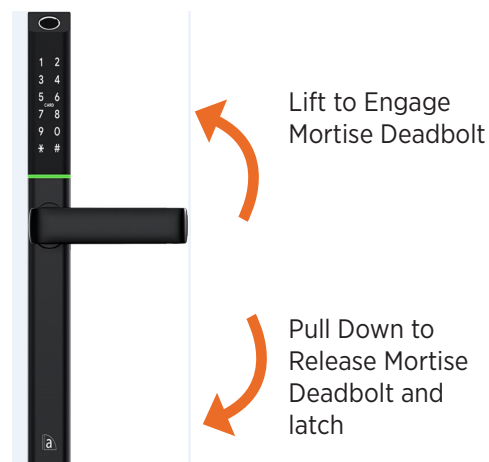

## Manually unlocking with Key

The Austyle 59407 Smart Lock has a mechanical key override to unlock it. The lock location is under the exterior panel.

Insert one of the included keys, turn and pull handle down to unlock.

Shown is the location of the mechanical key barrel, The Micro USB port beside it can be used to power up the Smart Lock if the batteries fail. When connected to a power bank or battery source, the Smart Lock can be powered up and then a PIN Code, RFID Card or the app can be used to unlock it.



## Maintenance Guide:

**Maintenance should be carried out on your lock every 6 months:**

- If the accuracy of the fingerprint reader decreases, please replace batteries.
- Check that the screws fixing the mortise Lock are tight.  
Check that the screws fixing the rear panel to the front panel are tight.
- Check if batteries need replacing. If battery percentage is low replace with four fresh Alkaline 1.5V AAA batteries.
- Wipe the surface of the Lock with a damp cloth, we recommend only water is used.  
This will help remove any dust or micro contaminants from the surface.

# TTLock App Set-up instructions:

---

## 1. Download app

- Download the TTlock app onto your device
- Through Apple (IOS version) use app store to download TTlock
- Through Android version go through Google play (English version)

Otherwise use the below QR codes



## TTlock App

- TTlock supports multiple types of locks and devices
- TTlock currently supports 200 countries
- Verification codes will be sent to user's mobile phone or email depending on how you have registered above.

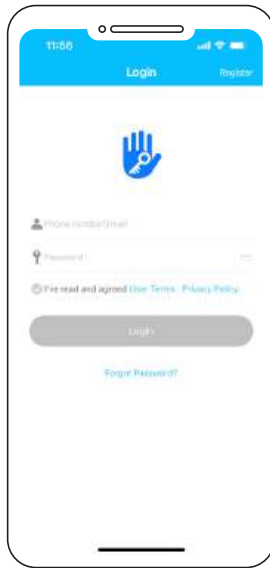

1. Register a new account (phone number or email) or login with an existing account if you already have one.

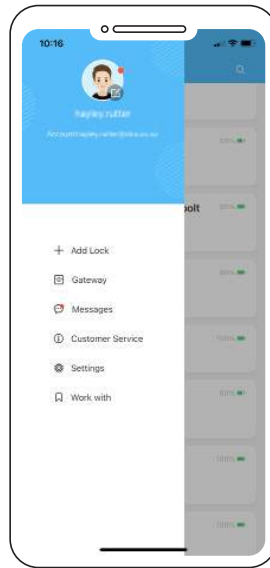

2. With App open touch on main screen + Add lock

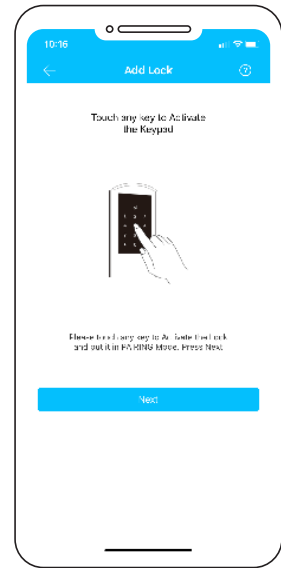

3. Hold the phone in close proximity to the lock (with four good-quality AAA alkaline batteries installed in the lock). Wake the lock by touching the keypad.

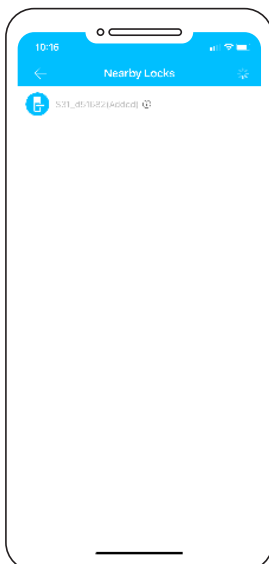

5. Rename the lock. e.g. home front door
6. The lock is now successfully added to the app.



7. If you have downloaded the app and loaded your lock on your device you are now the administrator of this lock, from here you can now add or delete users / passcodes / RFID card etc.

4. Your lock will appear on the screen, then click +

# Management of app and lock

## Bluetooth (lock and unlock)

- Make sure your phone has bluetooth switched on
- The app can be used to lock or unlock the door by using bluetooth within a 5m range.
- Note: the lock will automatically re-lock itself depending on the setup of the auto lock function through the app.
- From the app push the (padlock) symbol to lock or unlock the device.
- Note: 5-meter Bluetooth range can vary depending on interference such as steel, thick walls and microwave interference etc.

## Setting a passcode:

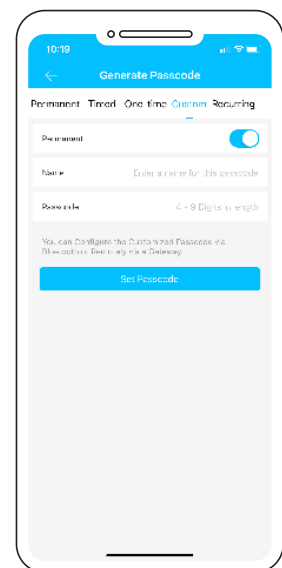
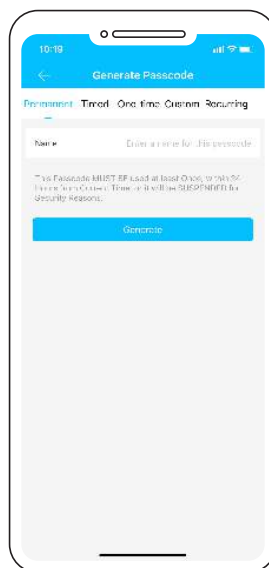
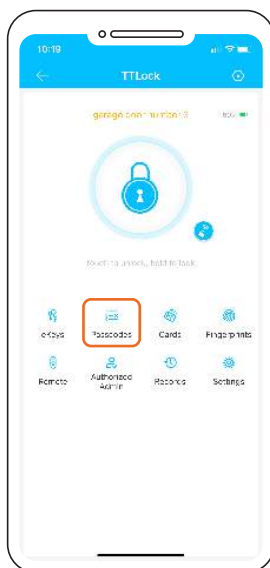

- Passcodes are another way of unlocking the device
- This lock can accept up to 150 unique Passcodes.
- Careful consideration should be taken to ensure each PIN is set up in a way that they can be well managed at a later time. We suggest naming each Passcode with the name of the person using it.  
E.g. Bobs PIN
- We suggest when setting up passcodes to do it via the custom setting to create your own pin number. It needs to be between 4-9 digits followed by '#'  
e.g. 1234#.
- Recurring Passcodes used to give access to the user of this code at certain time of day and week.
- You can also set up Passcodes for One-timed and also timed access (for example a tradesperson working in your house for a short period of time).

## Passcode Management

Click the 'Passcode' icon in the app. All generated passcodes can be viewed and managed in the passcode management module. This included options for changing, deleting, resetting, and unlocking records.

## Unlock Records

In the app, click the 'Records' icon to view your unlocking records, such as e-Keys, Passwords.

## Sending e-Key

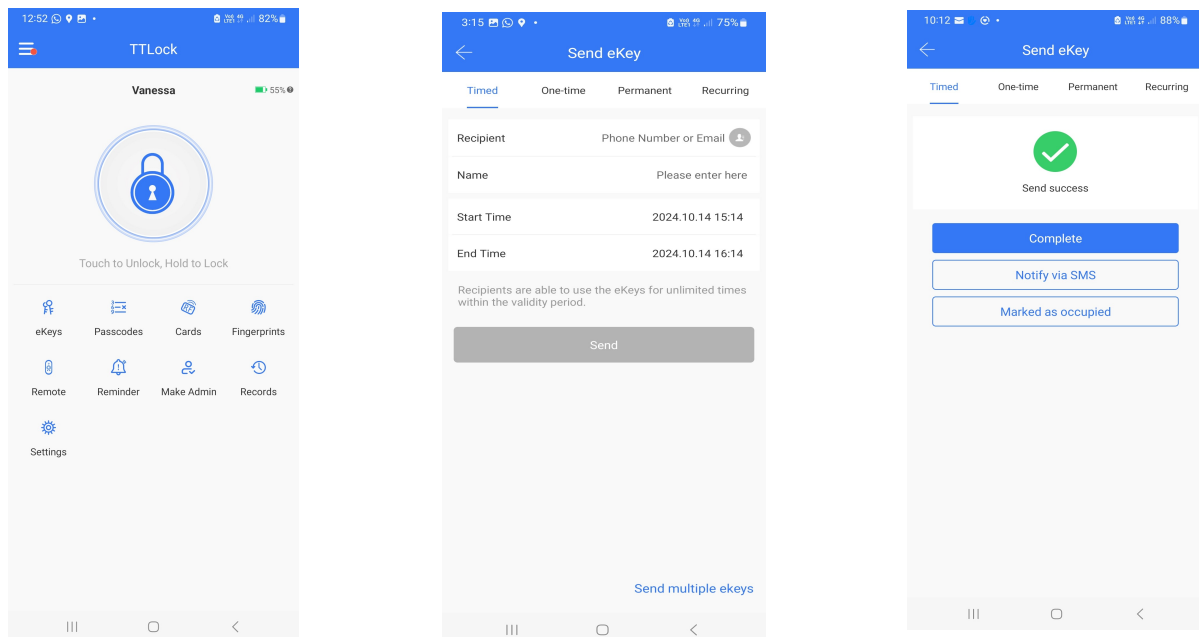

1. Choose an e-Key option: Timed, Permanent, One-Time or Recurring
2. Enter the recipient's details: name or email
3. Set the timing: Start time and End time
4. Save the setting.

You can also choose to allow or disallow remote unlocking, and specify whether the recipient is an authorized administrator or not.



## RFID cards

- This lock comes with three RFID cards and can store up to 200 unique RFID cards.

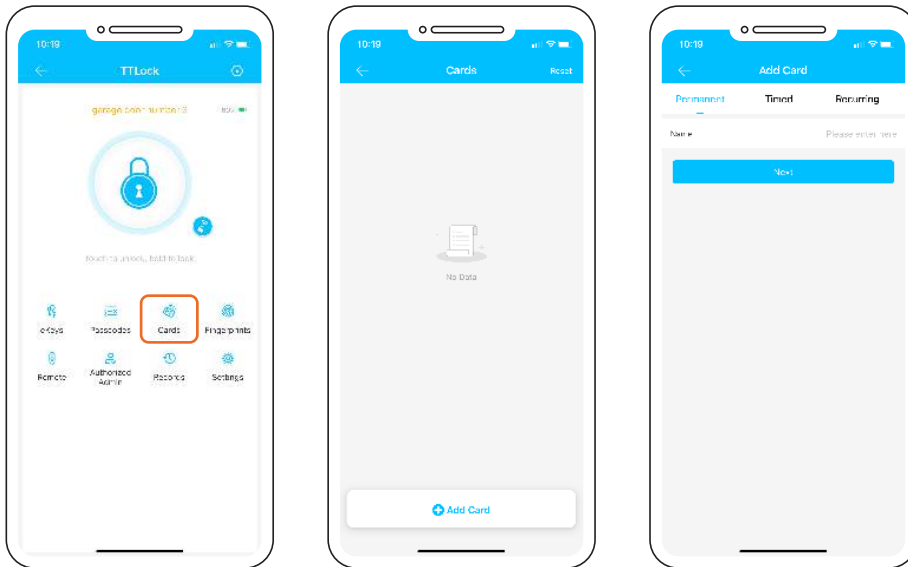

- To add these to the lock, touch RF Cards, then add card
- Decide if a Permanent or Timed or Recurring user
- Name the Card (we suggest the users name) e.g. Bobs RFID
- Then touch card against keypad to accept card to lock

## Passage mode

- The TT app can be used to put the lock into passage mode. NB: Passage mode is where the lock can be opened without a passcode etc

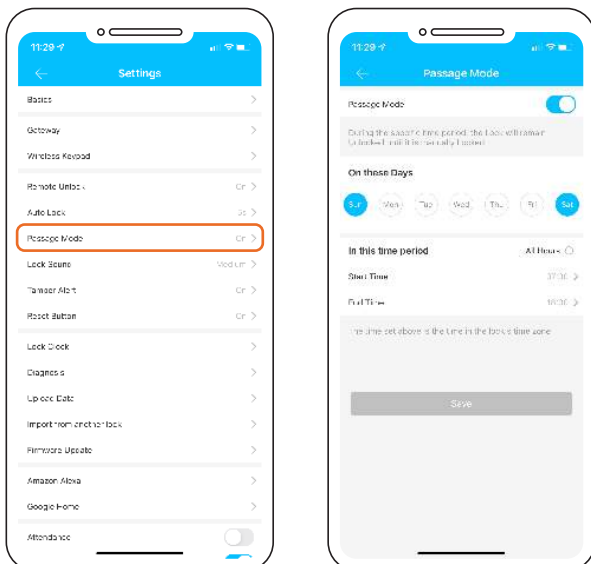

- Under the setting tab of the lock, you can switch passage mode on or off
- You can also set up a calendar so that the lock can go into passage mode on certain days at certain times.
- Note for security reasons the passage mode only starts once a successful entry to unlock the lock has been accepted.
- To lock the door when in passage mode, press and hold the # key on the lock.**

## Finger Prints

- This lock can accept up to 200 unique finger prints

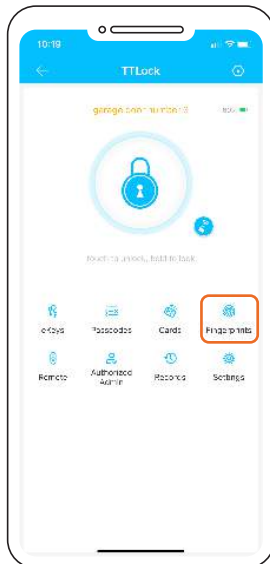

1. From main screen click on Finger print

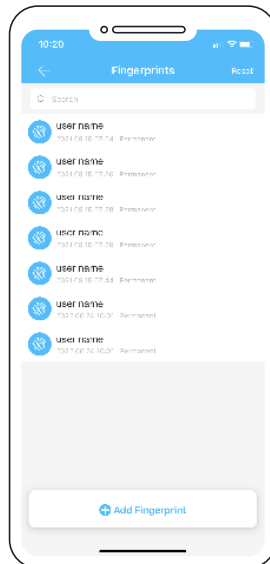

2. Then add finger print  
3. Decide if a Permanent, Timed or Recurring user

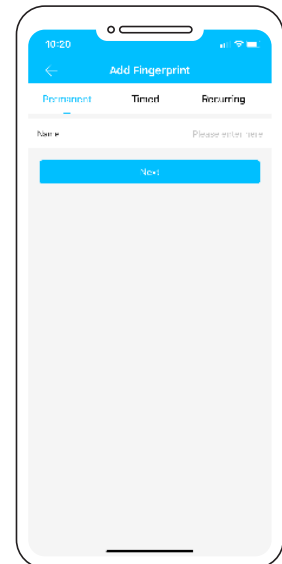

4. Name the finger print (we suggest the users name) eg Bobs Finger

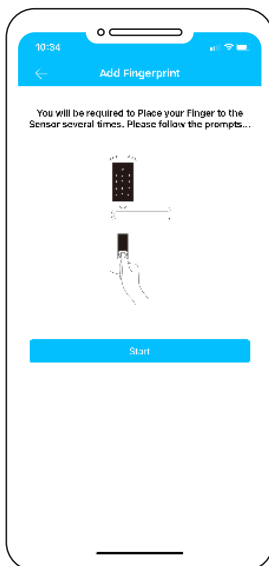

5. The app then prompts you to present your finger or thumb to the reader.  
6. Watch and listen to the prompt of the app and lock you will see the image



7. You will be asked to do this a number of times until all parts of the image on the app turn from black to blue.



8. We suggest for convenience and user speed to save your finger print in a number of different positions. EG Bobs 1 finger, Bobs 2 finger etc.

## Remote unlock

- This can be done using a WiFi hub 59419 (sold separately)

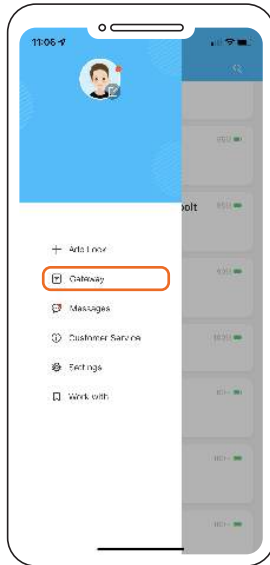

1. Add the WiFi hub via the first screen of the TTlock app

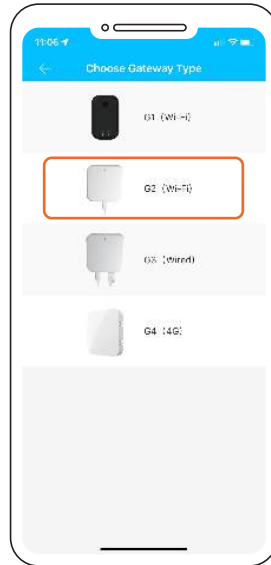

2. Click on add Gateway
3. Choose the G2 (Wi-Fi) option

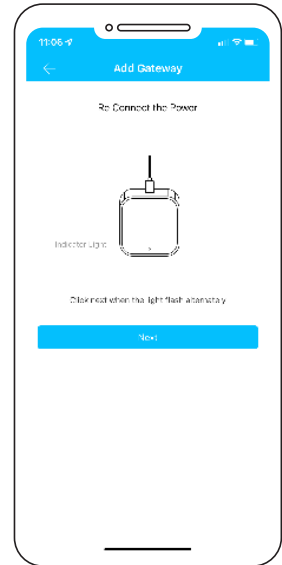

4. Connect power to the gateway and the indicator light will flash red, it's now in programming mode

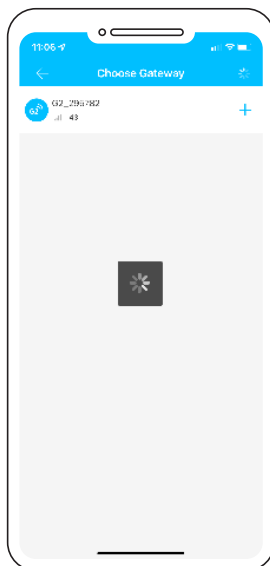

5. Click next
6. Once seen it will ask for you to name the gateway e.g. (garage door gate way)

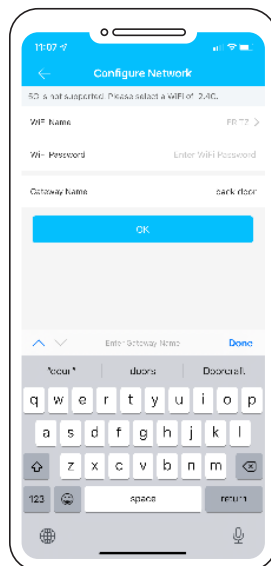

7. It will also ask for your WiFi password (Note this needs to be a 2.4G) signal. 5G is not supported
8. Then the gateway is connected.

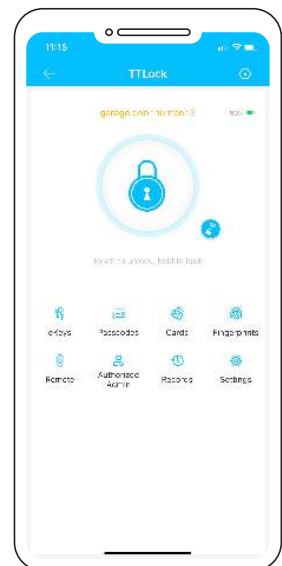

9. Check that the gateway is online under the gateway link off the front page
10. Ensure the gateway is within 10 meters of the lock

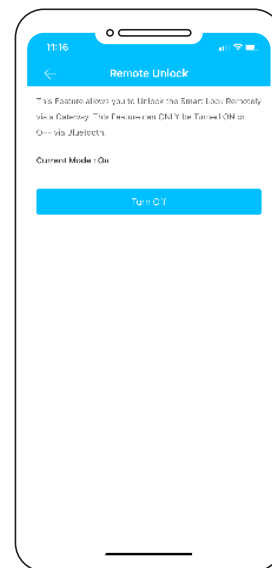
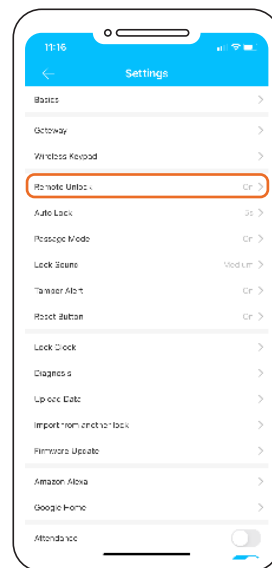
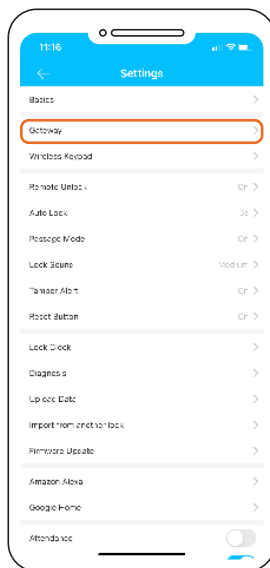

11. In the setting screen of the lock click on gateway and you should see your named gateway.

12. On the settings page select 'Turn on Remote Lock'.

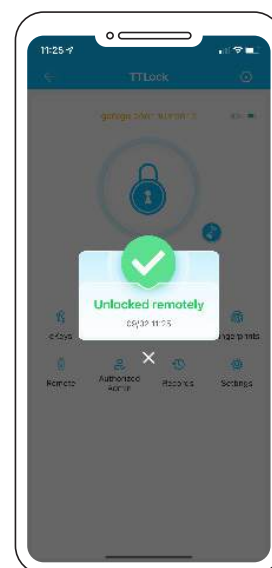
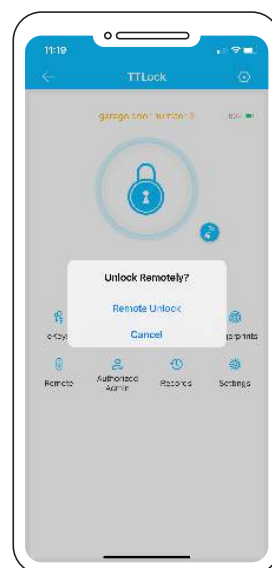
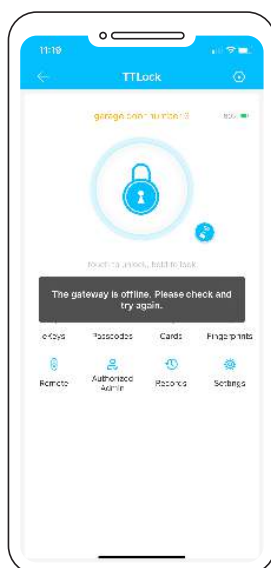

13. On the main programming screen of the lock a small WiFi symbol will now appear next to the padlock symbol of the app.

14. By clicking on the WiFi symbol, then clicking Remote unlock you will then be able to remotely unlock your lock from anywhere using the secure WiFi connection.

15. The app will show when the lock has been successfully unlocked.

## NOTES

[illegible]



## PRODUCT WARRANTY

Customer Name: \_\_\_\_\_

Customer Phone: \_\_\_\_\_

Purchase Date: \_\_\_\_\_

Store name: \_\_\_\_\_

Receipt #: \_\_\_\_\_

Product Name: \_\_\_\_\_

Product Model: \_\_\_\_\_

Note: \_\_\_\_\_

\_\_\_\_\_

\_\_\_\_\_

\_\_\_\_\_

Note:

1. Please keep this booklet and receipt so that you can use it when you need warranty service.

2. We provide you with a one-year warranty from the date of purchase.



137-145 Chesterville Rd  
Moorabbin VIC 3189  
Australia  
Ph: +61 3 9553 3559  
Email: [info@austyle.com.au](mailto:info@austyle.com.au)  
Web: [www.austyle.com.au](http://www.austyle.com.au)