

TRIO

TOOLS NEEDED FOR NEW INSTALLATION:

- Pencil
- Hammer
- 2-1/8" Hole Boring Bit
- Chisel
- Phillips Screwdriver
- Power Drill
- Tape Measure
- 1" & 1/8" Drill Bits
- 2" 6d Common Nail

INSTRUCTIONS FOR INSTALLATION OF LOCKSETS

Installation illustrations are shown with ENTRY models. Procedure is identical for Entry, Privacy, and Passage Models in any knob/lever design.

1. MARK DOOR

Mark door edge approximately 36"(914mm) from floor. Fold the template along fold line. Place center of template on marked position. Determine thickness of door.

- a.) Using template as guide, mark door edge with location for a 1"(25mm) diameter hole. This will be the latch hole.
 b.) Using template as a guide, mark the door face with the appropriate location for a 2-1/8"(54mm) hole. This will be the cylinder hole. This lockset is adjustable for either 2-3/8" or 2-3/4"(60mm or 70mm) backset.
 Note: This lockset is factory preset at 2-3/8"(60mm) backset.

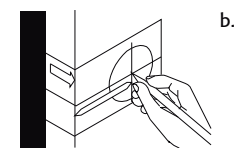
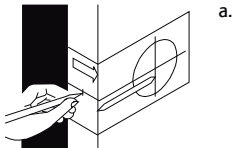

2. DRILL HOLES

Drill 1/8"(3mm) pilot holes as marked in step #1 for both the 2-1/8"(54mm) and 1"(25mm) holes.

- a.) Drill 2-1/8"(54mm) hole through the door face. It is recommended the hole be drilled from both sides to minimize splitting.
 b.) Before drilling the 1"(25mm) hole in the door edge, mark the center for the strike plate hole in the door jamb by closing the door and pressing a 2"(51mm) 6b common nail from inside the 2-1/8"(54mm) hole through the pilot hole until the nail makes an indentation on the door jamb.
 c.) Open the door and drill 1"(25mm) hole in the center of the door edge thru to the 2-1/8"(54mm) hole.
 d.) Next, drill 1"(25mm) hole in door jamb, at nail mark in (b.) above, a minimum of 1"(25mm) for strike.

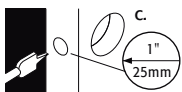
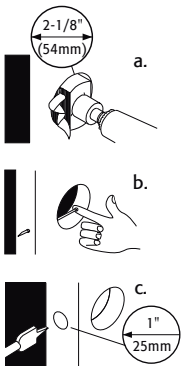

3. INSTALL LATCH

- a.) Install latch with desired faceplate configuration in the hole keeping latch parallel to the door face. Mark outline and remove latch.
 b.) Chisel 1/8" (3mm) deep or until latch face is flush with door edge (only if needed)
 c.) Install the latch so it will slide and lock when the door is in the closed position. Install screws into the holes on the faceplate.

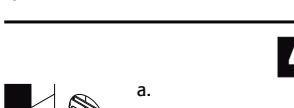
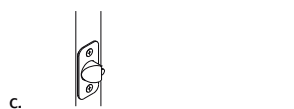

4. INSTALL STRIKE

Check center of strike hole for alignment with latch hole on the door to ensure free movement of the latch bolt.

- a.) Mark outline of strike plate centered over strike hole.
 b.) Remove strike plate and chisel 1/16"(2mm) deep or until strike plate face is flush with the jamb.
 c.) Align the strike plate and install flush. Insert and tighten two screws.

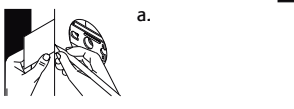

5. INSTALL EXTERIOR LEVER

- a.) Press exterior lever against exterior surface of the door making certain the stems are positioned horizontally so they go through holes in the latch case.
 Note: the exterior lever has no visible screws. If the door lock has a key hole,
 b.) For leverset, make sure that the key hole is in a horizontal position and the "key teeth" are facing the lever.

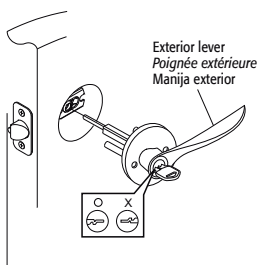

SPECIAL NOTE FOR PRIVACY FUNCTION (BED & BATH) LOCK:

No key required - for accidental locking from inside, insert a coin or a flat piece of metal in slot in outside lever and turn to release lock.(turn clockwise to release lever)

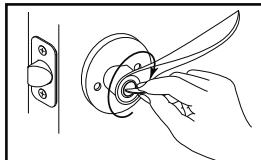

Determine door thickness and mark appropriate center line.

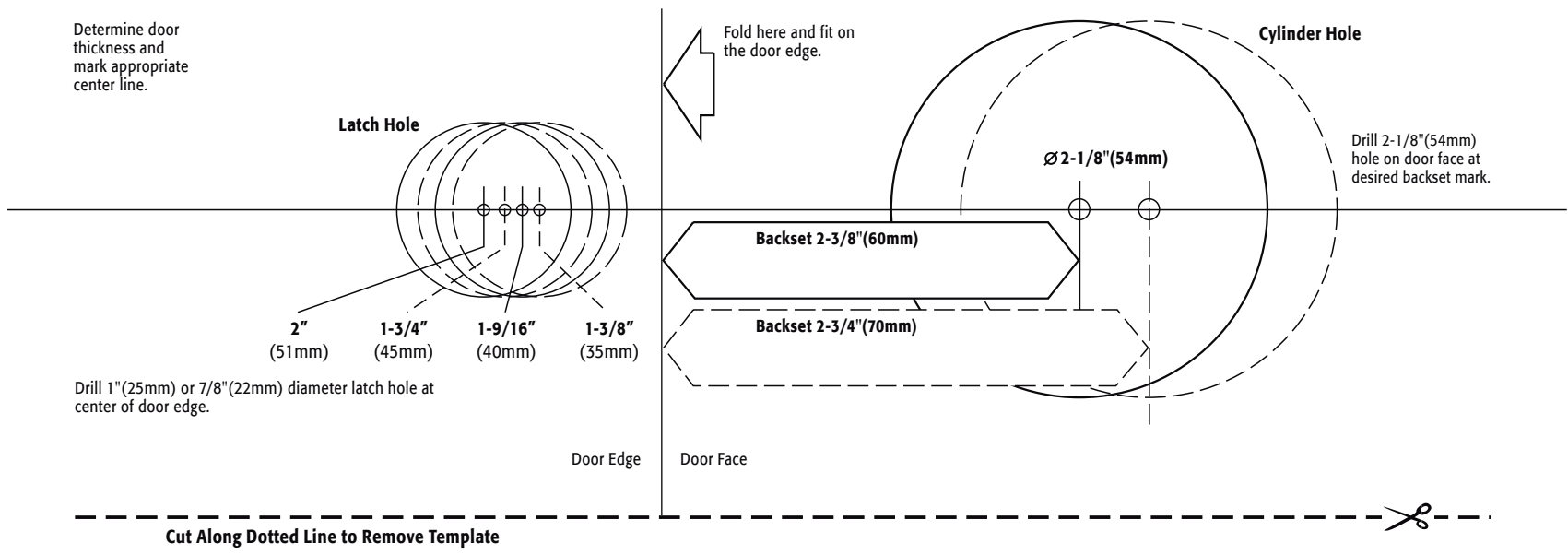

BEFORE PROCEEDING:

- A. Make sure backset of lock is same as backset of your door. If it is adjustable latch to be used please adjust the backset to fit your door as shown in step 6.
- B. Make sure handing of lock (LH or RH) fits your door. If not, adjust handing of lock as shown in step 7.
- C. Please read this instructions completely before attempting to install lock.

6

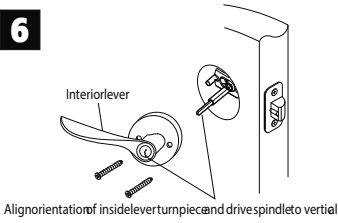

Align orientation of inside lever turn piece and drive spindle to vertical

INSTALL INTERIOR LEVER

Install interior Lever and rose by placing on spindle and aligning screw holes with stems. Push flush against the screws and make sure levers are in horizontal position. Tighten screw near the door edge first, then tighten the other side until lockset is firm.
 •To have proper leveling of lock levers to avoid sagging after installation, it is suggested to check lever orientation, both exterior and interior, to your preference before mounting screws are applied and securely tightened onto interior rose.

6

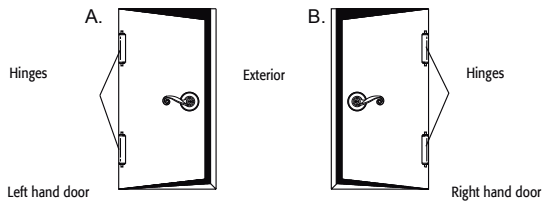

Stand at exterior side and face to your door.
 A. Your door is a left hand door if hinges are installed at your left hand.
 B. Your door is a right hand door if hinges are installed at your right hand.

7

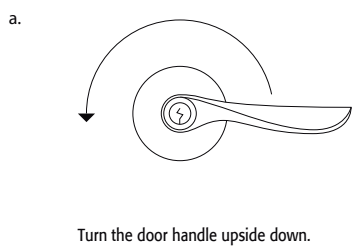

Turn the door handle upside down.

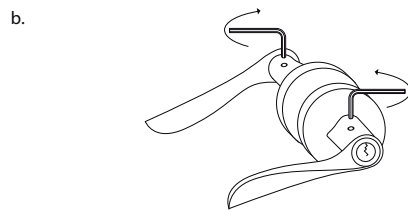

Use hex screw driver to remove screw on bottom of lever.

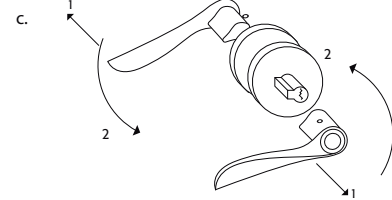

Pull levers off spindle then swap both levers

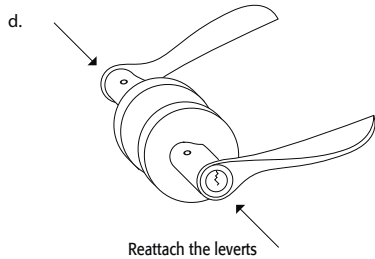

Reattach the levers

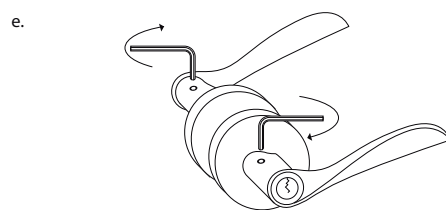

Use hex screw driver to tighten screw on bottom of lever.

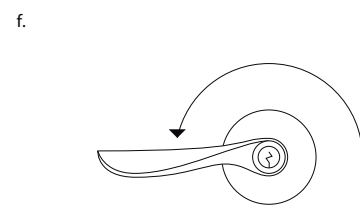

Turn the handle right side up.

TUBULAR LOCK UNIVERSAL BACKSET LATCHBOLT

THIS STEP IS FOR AN ADJUSTABLE LATCH ONLY. (NOT APPLICABLE TO 7/8" (22mm) FIXED 2-3/8" (60mm) BACKSET DRIVE IN LATCH FOR MOBILE HOME PRIVACY AND PASSAGE LOCKSET.) (THIS BACKSET ADJUSTMENT INSTRUCTION APPLIES ONLY WHEN ADJUSTMENT IS NECESSARY)

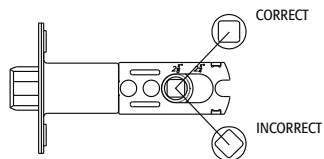

FACTORY PRESET 2-3/8" (60mm) BACKSET.

Latchbolt is preset at factory for 2-3/8" (60mm). CAUTION: Be sure the Latch Cam Driver is upright before making any backset adjustment.

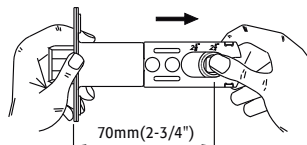

CONVERTING 2-3/8" to 2-3/4" (60mm to 70mm) BACKSET.

Pull the rear part of the latchbolt all the way back until the indicator is completely shown 2-3/4" (70mm).

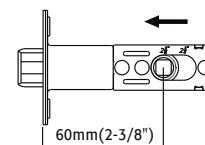

CONVERTING 2-3/4" to 2-3/8" (70mm to 60mm) BACKSET.

Push the rear part of the latch towards latch front until the indicator is completely shown 2-3/8" (60mm).

The following care instructions should be observed to insure a long lasting finish: 1. Remove locks, or do not install locks, prior to painting door. 2. Clean only with mild soap and a soft cloth; avoid abrasives (such as steelwool or cleansers) degreasers or lacquer thinners, and sharp objects.